

Lilly Rd - 9 acres - Carroll County
0 Lilly Rd
Minerva, OH 44657

\$94,900
9.970± Acres
Carroll County



Lilly Rd - 9 acres - Carroll County
Minerva, OH / Carroll County

SUMMARY

Address

0 Lilly Rd

City, State Zip

Minerva, OH 44657

County

Carroll County

Type

Recreational Land

Latitude / Longitude

40.6781 / -81.1276

Taxes (Annually)

678

Acreage

9.970

Price

\$94,900

Property Website

<https://www.mossyoakproperties.com/property/lilly-rd-9-acres-carroll-county-carroll-ohio/48613/>

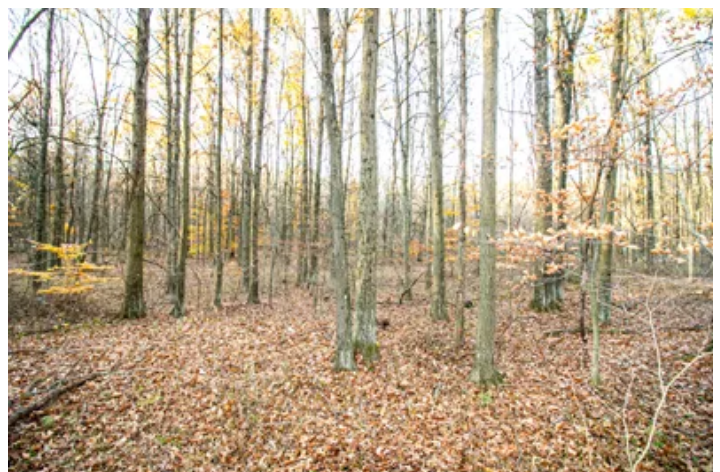

Lilly Rd - 9 acres - Carroll County
Minerva, OH / Carroll County

PROPERTY DESCRIPTION

Land for sale in Carroll County Ohio. Just under 10 acres of beautiful, wooded property. Park-like setting with nice hardwood trees and flowing creek. Great potential for a home or cabin site. Very desirable area and relaxing setting.

Property Features:

- Year-round flowing creek
- Minutes from both Minerva and Malvern
- Completely wooded
- Approx. 650 ft. of frontage on Lilly Rd.
- Beautiful hardwood trees
- Established pull off that could be extended into a driveway
- Gas-line ROW would make a great area for wildlife food plots
- Great deer activity
- Property lines and corners are marked with ribbon
- A portion of the creek bottom falls within the 100-year floodplain.
- GPS Coordinates: 40.6781, -81.1276
- Park-like setting
- Adjoins larger timber tracts
- Great potential for home or cabin site
- Power at the road
- Would need well and septic for a home.
- Just a short drive to Lake Mohawk

Should make a great hunting property as the cellular trail camera gets photos all throughout the day. Sellers do not own the mineral rights.

Lilly Rd - 9 acres - Carroll County
Minerva, OH / Carroll County



Locator Map

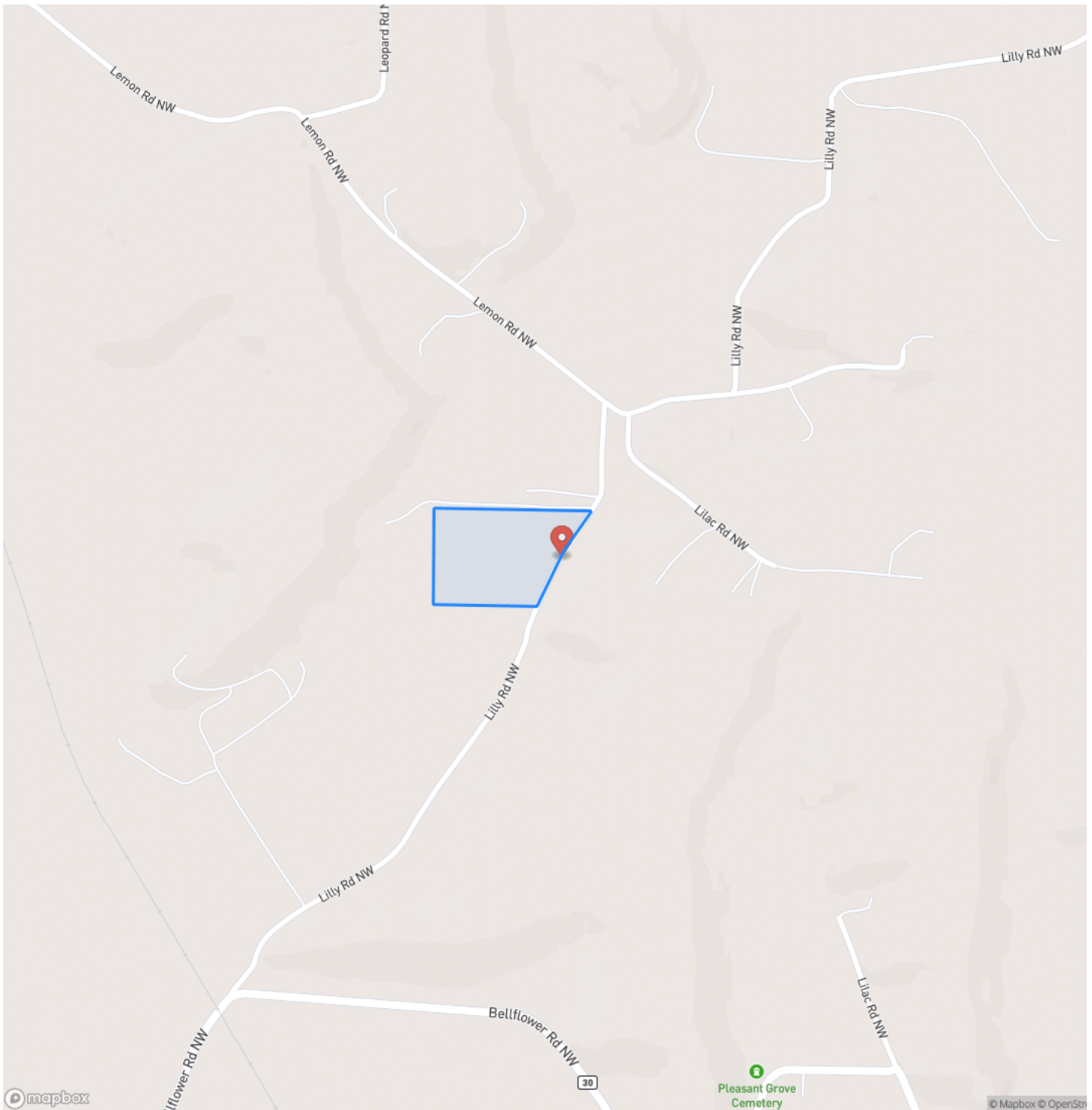

Locator Map

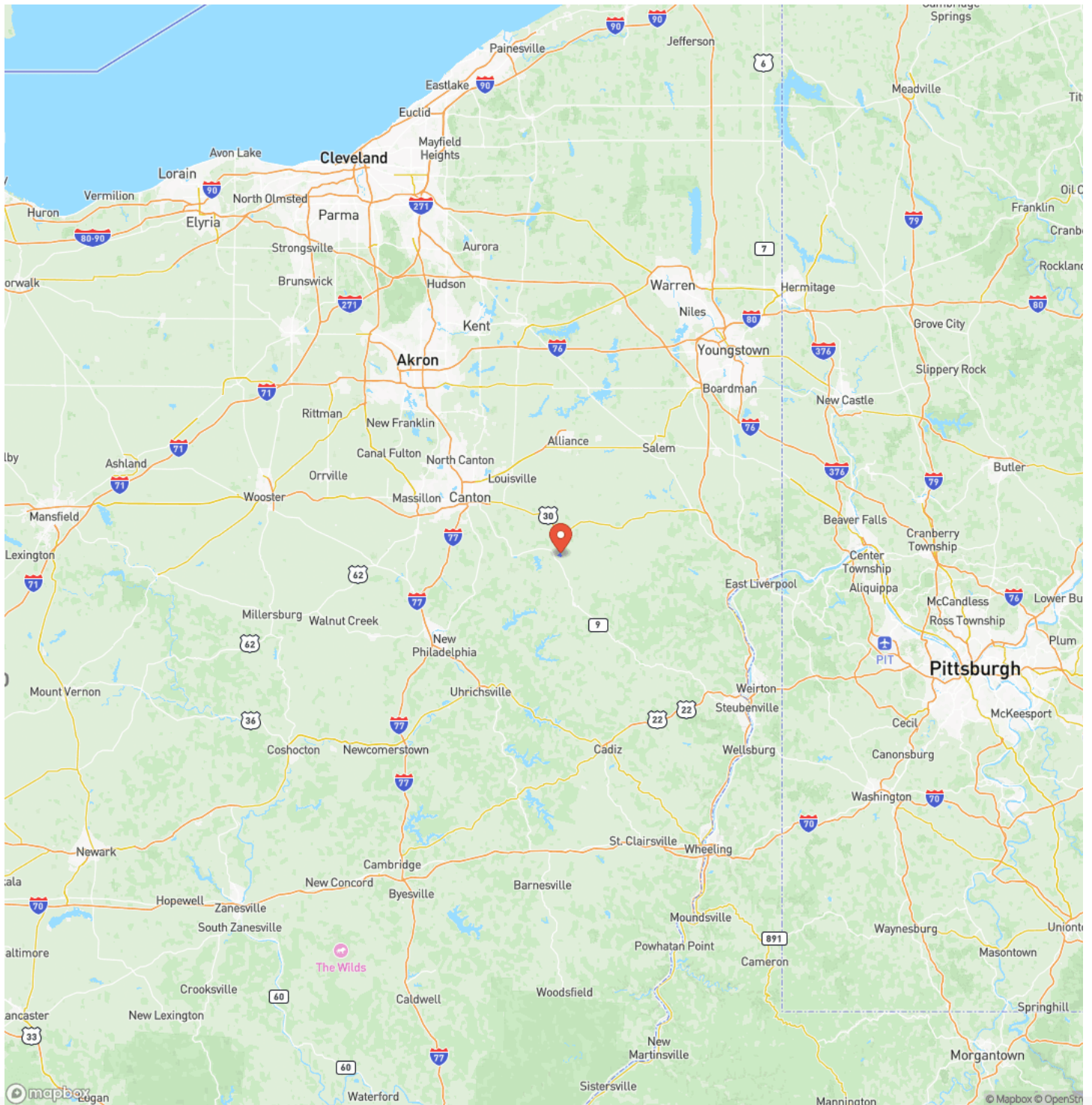

Satellite Map



Lilly Rd - 9 acres - Carroll County
Minerva, OH / Carroll County

LISTING REPRESENTATIVE

For more information contact:



Representative

Tony Seals

Mobile

(567) 241-5107

Email

tseals@mossyoakproperties.com

Address

PO Box 896

City / State / Zip

Pickerington, OH 43147

NOTES



MORE INFO ONLINE:

www.mossyoakproperties.com/land-for-sale/ohio/

This image shows a blank sheet of white paper with horizontal ruling lines. The lines are evenly spaced and run across the width of the page. There are no margins, text, or other markings on the paper.



www.mossoakproperties.com/land-for-sale/ohio/

DISCLAIMERS

Information in this brochure is provided solely for information purposes and does not constitute an offer to sell or advertise real estate outside the states in which broker or agent licensed. The information presented has been obtained from sources deemed to be reliable, but is not guaranteed or warranted by the agent, broker, or the sellers of these properties. This offering is subject to errors, omissions, prior sale, price change, correction or withdrawal from the market without notice. All references to age, square footage, income, expenses, acreage, carrying capacity, and land classification, etc. are approximate. Prospective buyers are chargeable with and expected to conduct their own independent investigation of the information and the property and to rely only on those results. Sellers reserve the right to accept or reject any and all offers without liability to any buyer or cooperating broker.

Maps are provided for illustration purposes only, the accuracy is not warranted. Parcels on interactive maps are not adjusted to match aerial backgrounds. This information is for reference purposes only and is not a legal document. Data maps contain errors. The seller and seller's agent are making known to all potential buyers that there may be variations between the location of the existing fence lines and the legal description of the deeded property. Seller and seller's agent make no warranties with regard to the location of the fence lines in relationship to the deeded property lines, nor does the Seller make any warranties or representations with regard to the specific acreage contained within the fenced property lines. Seller is selling the property in an "as is" condition, which includes the location of the fences as they exist. Boundaries shown on the accompanying maps are approximate, based on county parcel data. The maps are not to scale. The accuracy of the maps is not guaranteed. Prospective buyers are encouraged to verify fence lines, deeded property lines and acreages using a licensed surveyor at their own expense.

Mossy Oak Properties Bauer Real Estate
PO BOX 896
Pickerington, OH 43147
(614) 949-6764
www.mossyOakproperties.com/land-for-sale/ohio/

