

**Tract # 011104**  
**H & W Enterprises, LLC**  
**Hollis 126 Tract**  
**Compartment 1**  
**Marlboro County, SC**  
**126.11 Acres**

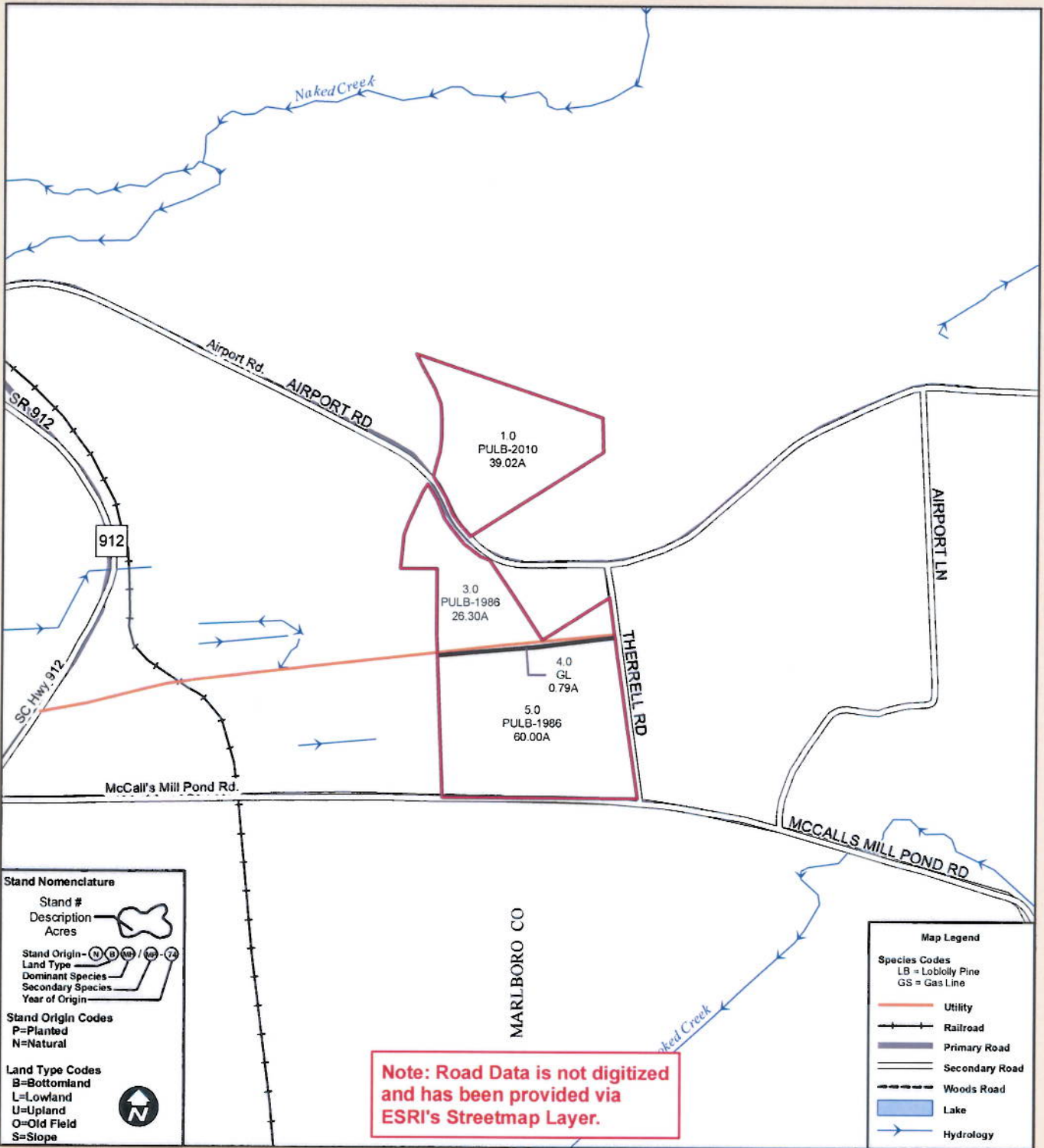

**Stand Nomenclature**

Stand #  
Description  
Acres

Stand Origin - (N) (B) (U) (O) (S) (74)

Land Type  
Dominant Species  
Secondary Species  
Year of Origin

**Stand Origin Codes**  
P=Planted  
N=Natural

**Land Type Codes**  
B=Bottomland  
L=Lowland  
U=Upland  
O=Old Field  
S=Slope

**Map Legend**

**Species Codes**  
LB = Loblolly Pine  
GS = Gas Line

Utility  
Railroad  
Primary Road  
Secondary Road  
Woods Road  
Lake  
Hydrology

**Note: Road Data is not digitized and has been provided via ESRI's Streetmap Layer.**

