

Tract # 011097
H & W Enterprises, LLC
Lumber River B Tract
Compartment 1
Robeson County, NC
270.00 Acres

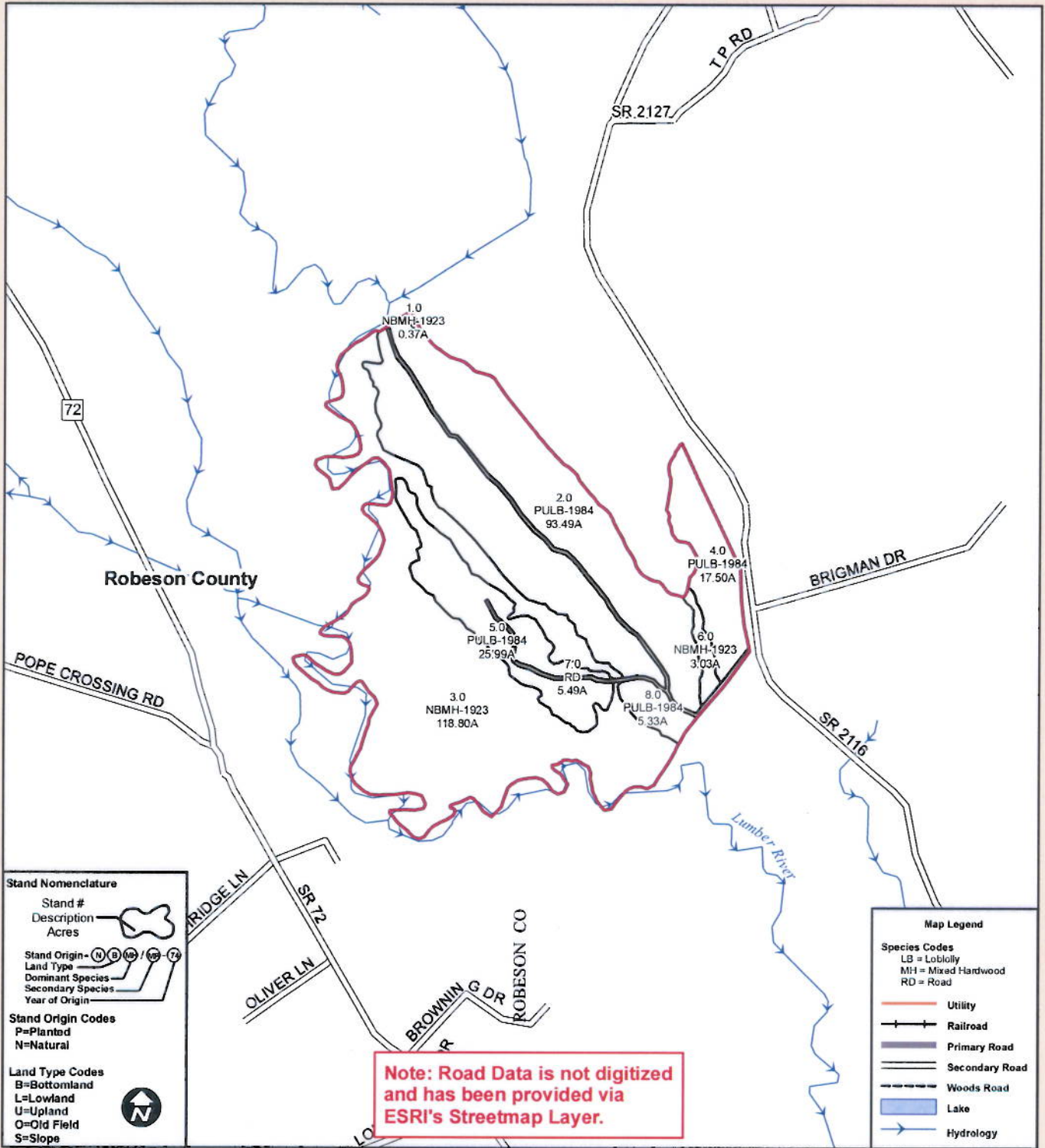
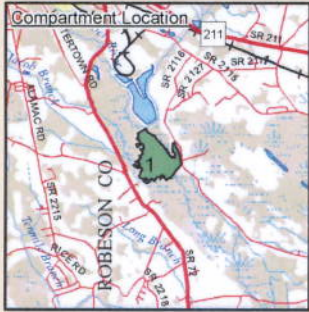

Stand Nomenclature

Stand #
Description
Acres

Stand Origin - (N) (B) (M) (O) (S)

Land Type
Dominant Species
Secondary Species
Year of Origin

Stand Origin Codes
P=Planted
N=Natural

Land Type Codes
B=Bottomland
L=Lowland
U=Upland
O=Old Field
S=Slope

Map Legend

Species Codes
LB = Loblolly
MH = Mixed Hardwood
RD = Road

Utility
Railroad
Primary Road
Secondary Road
Woods Road
Lake
Hydrology

Note: Road Data is not digitized and has been provided via ESRI's Streetmap Layer.

