

**Tract # 011100**  
**H & W Enterprises, LLC**  
**Duke Tract**  
**Compartment 1**  
**Chesterfield County, SC**  
**317.00 Acres**

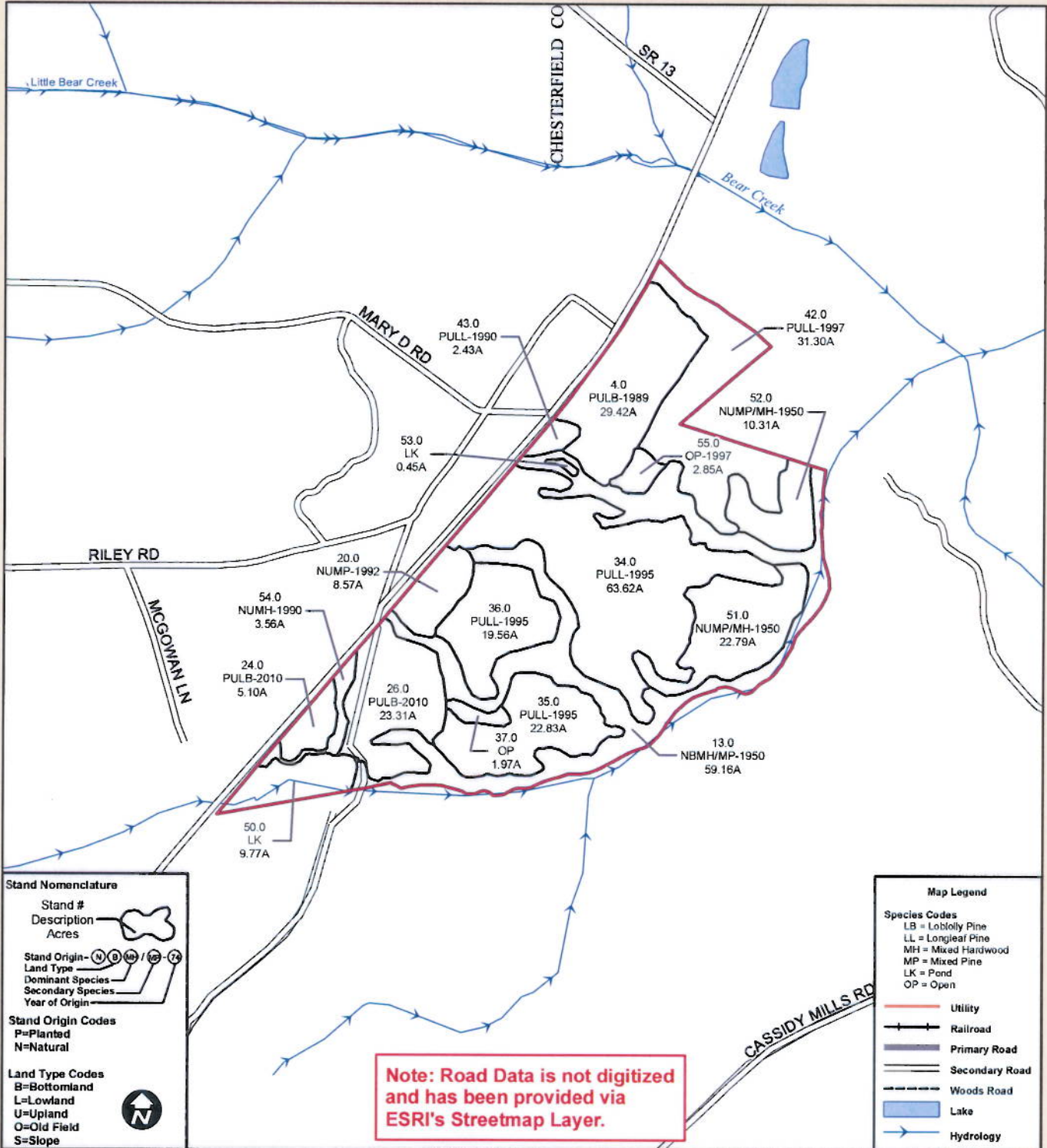
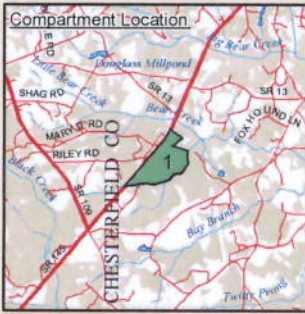

**Stand Nomenclature**

Stand #  
Description  
Acres

Stand Origin - (N) (B) (MH) (OP) (OK)

Land Type  
Dominant Species  
Secondary Species  
Year of Origin

Stand Origin Codes  
P=Planted  
N=Natural

Land Type Codes  
B=Bottomland  
L=Lowland  
U=Upland  
O=Old Field  
S=Slope

**Map Legend**

**Species Codes**  
LB = Loblolly Pine  
LL = Longleaf Pine  
MH = Mixed Hardwood  
MP = Mixed Pine  
LK = Pond  
OP = Open

Utility  
Railroad  
Primary Road  
Secondary Road  
Woods Road  
Lake  
Hydrology

**Note: Road Data is not digitized and has been provided via ESRI's Streetmap Layer.**