

**Calaway Ridge Rd - 15 acres - Athens
County**
0 Calaway Ridge Rd
Coolville, OH 45723

\$48,500
15.700 +/- acres
Athens County

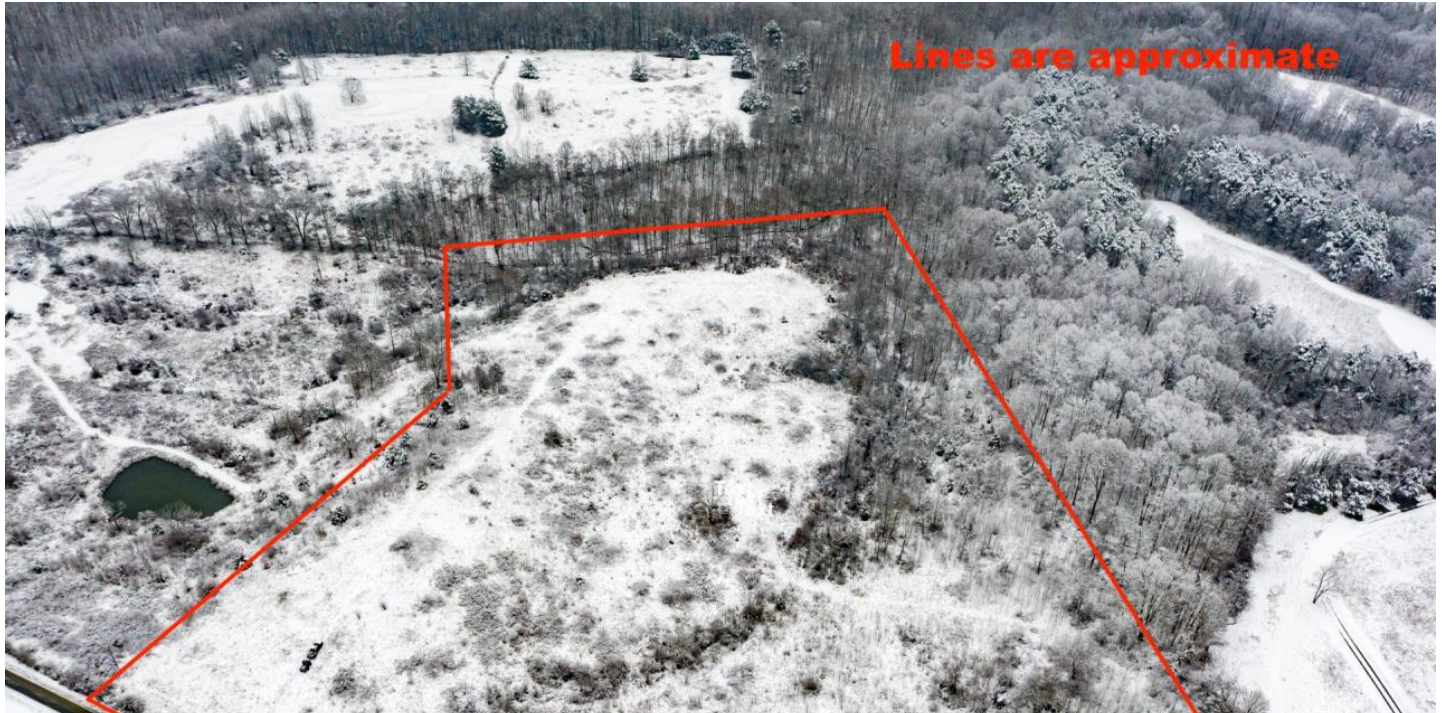

Calaway Ridge Rd - 15 acres - Athens County
Coolville, OH / Athens County

SUMMARY

Address

0 Calaway Ridge Rd

City, State Zip

Coolville, OH 45723

County

Athens County

Type

Hunting Land, Recreational Land

Latitude / Longitude

39.187138 / -81.877593

Acreage

15.700

Price

\$48,500

Property Website

<https://ohiolandforsale.com/property/calaway-ridge-rd-15-acres-athens-county-athens-ohio/11418>



PROPERTY DESCRIPTION

Land for sale in Athens County Ohio. Here is a great opportunity to purchase 15.7 acres of undeveloped land. Located 30 minutes from Athens, this property offers lots of opportunities to the outdoors-man.

Property features include:

- Good cover and bedding for wildlife
- Electric service along road
- Topography is gradual slope down from the road
- Quiet setting
- Approximately 925' of road frontage
- Building sites
- Excellent hunting!
- New Survey

Annual taxes to be determined. All mineral rights owned by the seller will transfer. If you are looking for a well priced weekend retreat or hunting camp this would be one to have a look at.

Calaway Ridge Rd - 15 acres - Athens County
Coolville, OH / Athens County

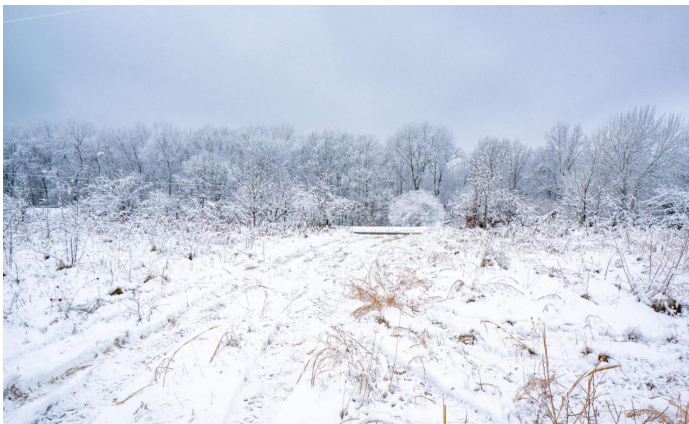

Locator Maps

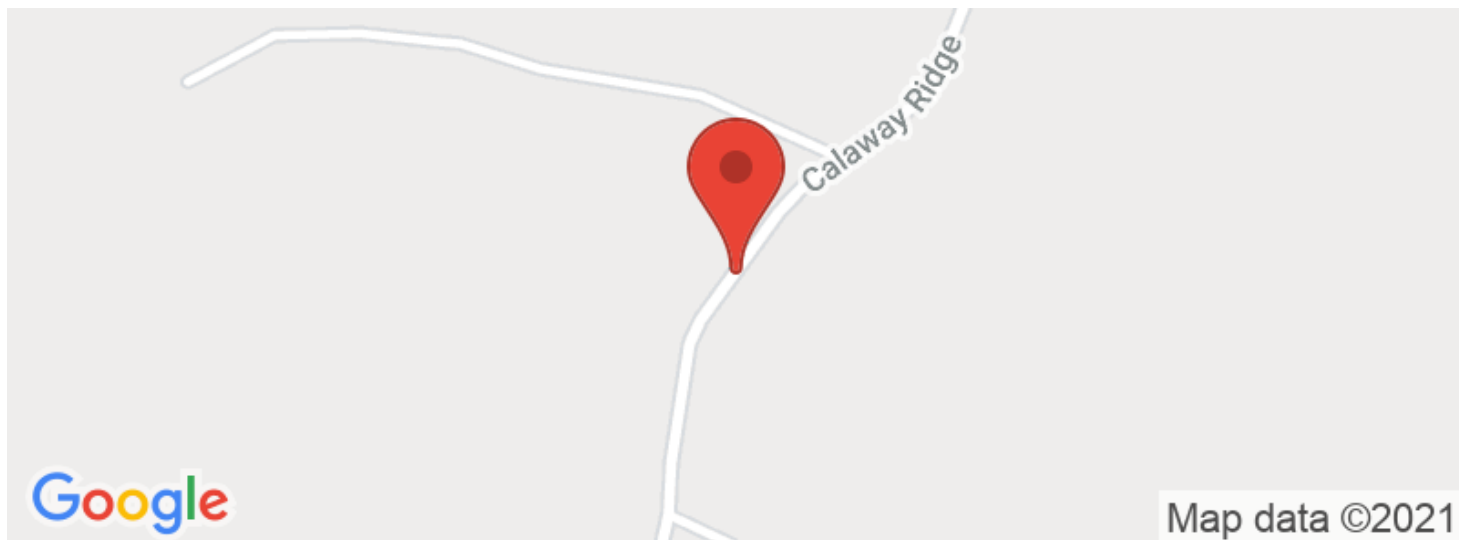

Aerial Maps

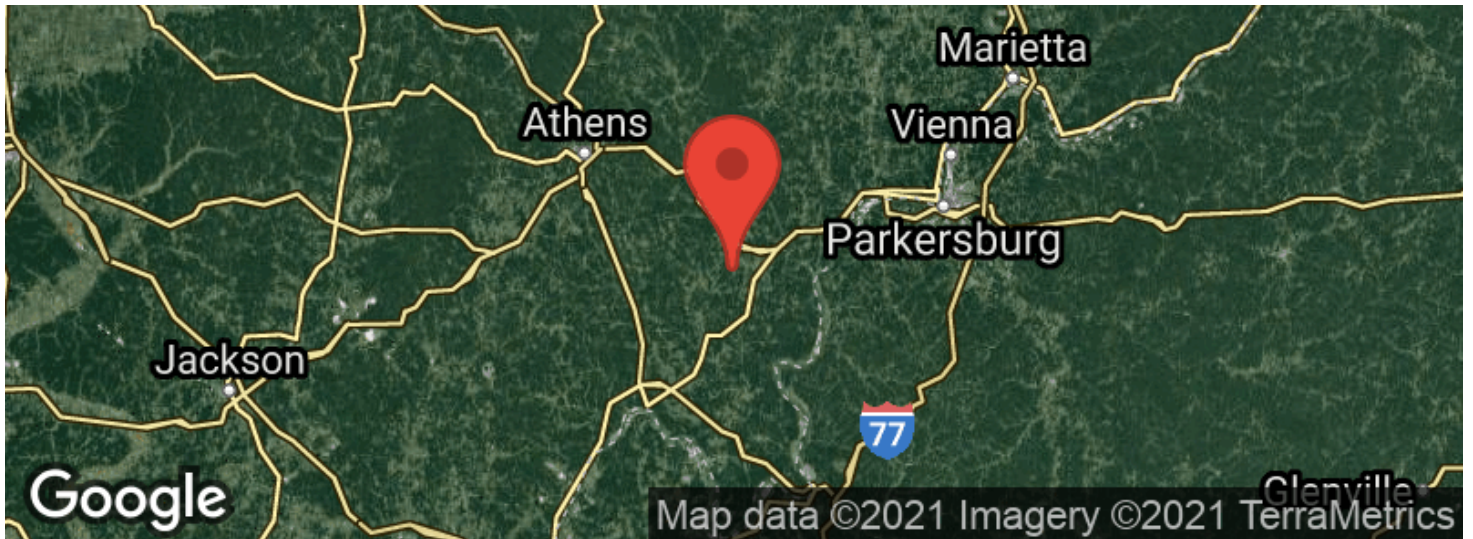

Calaway Ridge Rd - 15 acres - Athens County
Coolville, OH / Athens County

LISTING REPRESENTATIVE

For more information contact:



Representative

Jonathan Davis

Mobile

(614) 330-5902

Email

jdavis@mossyoakproperties.com

Address

6465 LITHOPOLIS ROAD NW

City / State / Zip

CARROLL, OH, 43112

NOTES

This image shows a blank sheet of white paper with horizontal ruling lines. The lines are evenly spaced and run across the width of the page. There are no margins, text, or other markings on the paper.



DISCLAIMERS

Information in this brochure is provided solely for information purposes and does not constitute an offer to sell or advertise real estate outside the states in which broker or agent licensed. The information presented has been obtained from sources deemed to be reliable, but is not guaranteed or warranted by the agent, broker, or the sellers of these properties. This offering is subject to errors, omissions, prior sale, price change, correction or withdrawal from the market without notice. All references to age, square footage, income, expenses, acreage, carrying capacity, and land classification, etc. are approximate. Prospective buyers are chargeable with and expected to conduct their own independent investigation of the information and the property and to rely only on those results. Sellers reserve the right to accept or reject any and all offers without liability to any buyer or cooperating broker.

Maps are provided for illustration purposes only, the accuracy is not warranted. Parcels on interactive maps are not adjusted to match aerial backgrounds. This information is for reference purposes only and is not a legal document. Data maps contain errors. The seller and seller's agent are making known to all potential buyers that there may be variations between the location of the existing fence lines and the legal description of the deeded property. Seller and seller's agent make no warranties with regard to the location of the fence lines in relationship to the deeded property lines, nor does the Seller make any warranties or representations with regard to the specific acreage contained within the fenced property lines. Seller is selling the property in an "as is" condition, which includes the location of the fences as they exist. Boundaries shown on the accompanying maps are approximate, based on county parcel data. The maps are not to scale. The accuracy of the maps is not guaranteed. Prospective buyers are encouraged to verify fence lines, deeded property lines and acreages using a licensed surveyor at their own expense.

Mossy Oak Properties Bauer Real Estate
PO BOX 896
Pickerington, OH 43147
(614) 949-6764
OhioLandForSale.com
