

Soils Map

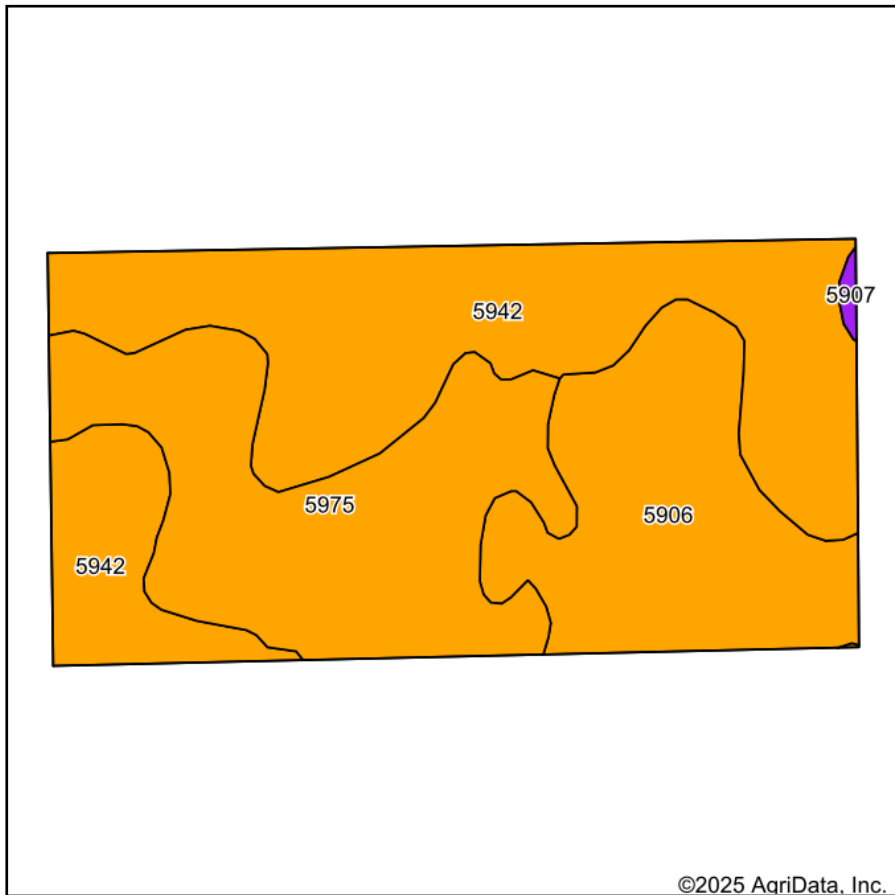

Soils data provided by USDA and NRCS.

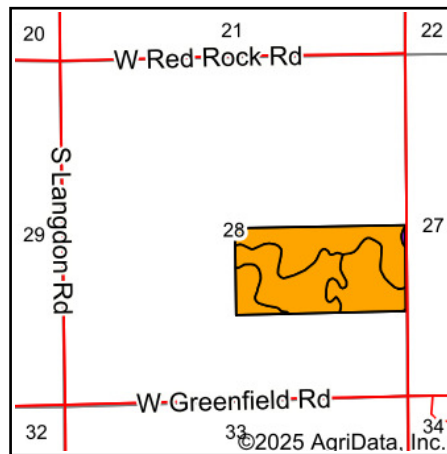

State: **Kansas**
 County: **Reno**
 Location: **28-24S-9W**
 Township: **Plevna**



Maps Provided By:



Area Symbol: KS155, Soil Area Version: 22

Code	Soil Description	Acres	Percent of field	Non-Irr Class Legend	Non-Irr Class	Irr Class	*n NCCPI Corn	*n NCCPI Small Grains	*n NCCPI Soybeans
5942	Pratt-Turon fine sands, 1 to 5 percent slopes	35.81	45.0%		IIIe	Ile	37	36	37
5975	Turon-Carway complex, 0 to 5 percent slopes	24.25	30.5%		IIIe	Ile	46	40	48
5906	Hayes-Turon complex, 0 to 5 percent slopes	19.30	24.2%		IIIe	Ile	45	46	49
5907	Langdon fine sand, 0 to 15 percent slopes	0.27	0.3%		Vle		27	26	24
Weighted Average					3.01	*-	*n 41.6	*n 39.6	*n 43.2

*n: The aggregation method is "Weighted Average using all components"

*- Irr Class weighted average cannot be calculated on the current soils data due to missing data.