

Soils Map

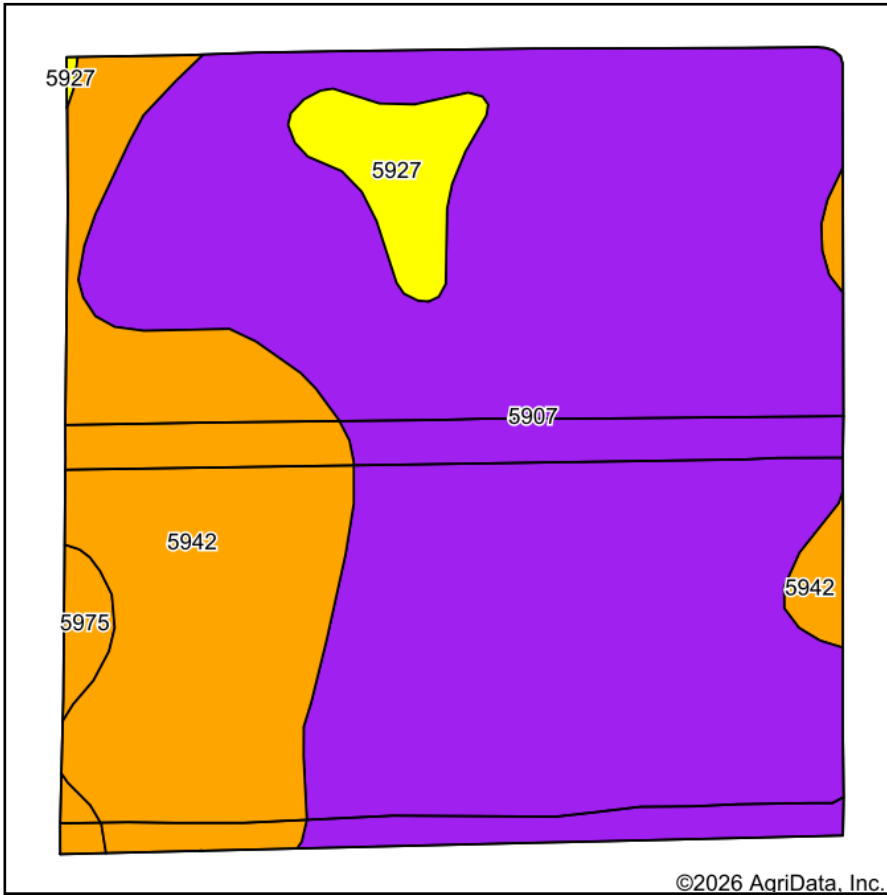

Soils data provided by USDA and NRCS.

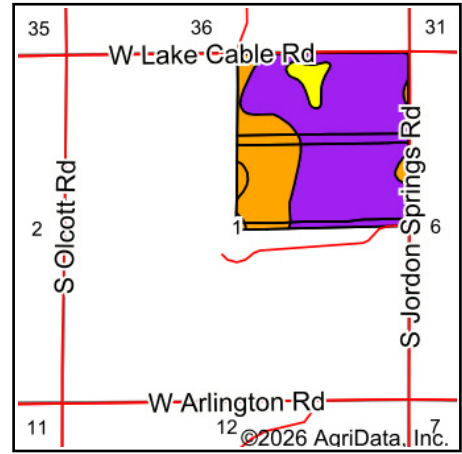

State: **Kansas**
 County: **Reno**
 Location: **1-25S-10W**
 Township: **Grove**



Maps Provided By:



Area Symbol: KS155, Soil Area Version: 22

Code	Soil Description	Acres	Percent of field	Non-Irr Class Legend	Non-Irr Class	Irr Class	*n NCCPI Overall	*n NCCPI Corn	*n NCCPI Small Grains
5907	Langdon fine sand, 0 to 15 percent slopes	113.34	71.3%		Vle		27	27	26
5942	Pratt-Turon fine sands, 1 to 5 percent slopes	37.84	23.8%		IIle	Ile	39	37	36
5927	Pratt fine sand, 5 to 10 percent slopes	5.61	3.5%		IVe	IIle	31	31	30
5975	Turon-Carway complex, 0 to 5 percent slopes	2.17	1.4%		IIle	Ile	48	46	40
Weighted Average					5.17	*-	*n 30.3	*n 29.8	*n 28.7

*n: The aggregation method is "Weighted Average using all components"

*- Irr Class weighted average cannot be calculated on the current soils data due to missing data.

Soils data provided by USDA and NRCS.