

Soils Map

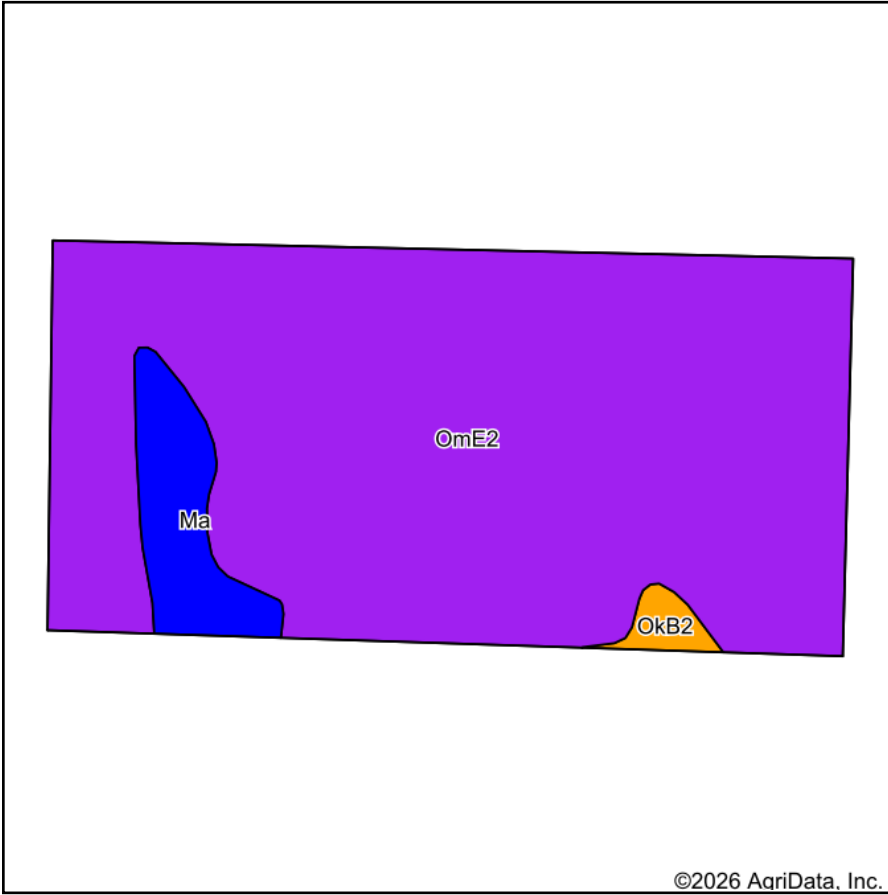

Soils data provided by USDA and NRCS.

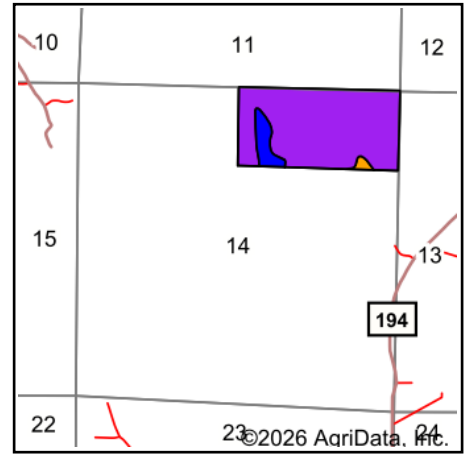

State: **Mississippi**
 County: **Union**
 Location: **14-8S-4E**
 Township: **District 4**
 Acres: **80.99**
 Date: **4/6/2026**

Darrell W. Bullock, MAI, SRA, ARA
 Bullock Appraisal Services, LLC



Area Symbol: MS145, Soil Area Version: 20

Code	Soil Description	Acres	Percent of field	Non-Irr Class Legend	Non-Irr Class *c	Bahiagrass AUM	Corn Bu	Cotton lint Lbs	Grass hay Tons	Grass clover AUM	Oats Bu	Soybeans Bu	Tall fescue AUM	Warm season grasses AUM	Wheat Bu	*n NCCPI Overall
OmE2	Oktibbeha-Sweatman-Smithdale complex 12 to 20 percent slopes eroded	74.33	91.7%		Vle				4.5	7.5						64
Ma	Mantachie silt loam, 0 to 2 percent slopes, occasionally flooded	5.55	6.9%		Ilw	10	90	650				35	10	9	40	70
OkB2	Oktibbeha silt loam 2 to 5 percent slopes eroded	1.11	1.4%		Ille		55	550	5	8.5	55	35			35	58
Weighted Average					5.68	0.7	6.9	52.1	4.2	7	0.8	2.9	0.7	0.6	3.2	*n 64.3

*n: The aggregation method is "Weighted Average using all components"

*c: Using Capabilities Class Dominant Condition Aggregation Method

Soils data provided by USDA and NRCS.