

# Soils Map

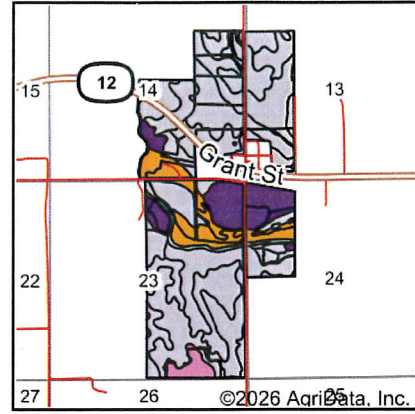

State: **Nebraska**  
 County: **Boyd**  
 Location: **23-33N-9W**  
 Township: **Bush**  
 Acres: **655.38**  
 Date: **7/6/2026**

**MOSSY OAK.**  
**PROPERTIES**  
 Homestead Land & Auction Co. Inc.  
 America's Land Specialist

Maps Provided By



Soils data provided by USDA and NRCS.

Area Symbol: NE015, Soil Area Version: 27

Code	Soil Description	Acres	Percent of field	NCCPI Overall Legend	Non-Irr Class *c	Irr Class *c	SRPG	*n NCCPI Overall	*n NCCPI Corn	*n NCCPI Soybeans
3234	Monowi-Bristow silty clays, 9 to 35 percent slopes	126.50	18.9%		Vle	Vle	3	21	11	16
4493	Dunday loamy fine sand, 6 to 11 percent slopes	72.52	11.1%		Vle	IVe	28	35	28	27
3235	Monowi-Verdel silty clays, 6 to 15 percent slopes	67.13	10.2%		IVe	IVe	18	28	15	24
8840	Hall silt loam, 0 to 1 percent slopes	58.85	9.0%		IIc	I	71	69	50	69
6300	Aowa silt loam, 0 to 3 percent slopes, occasionally flooded	58.68	9.0%		IIw	IIw	56	77	68	76
3320	Sansarc silty clay, 9 to 35 percent slopes	51.92	7.9%		VIIe		0	20	10	14
3152	Boyd silty clay, 6 to 11 percent slopes	47.76	7.3%		IVe		20	36	19	28
3225	Labu-Sansarc silty clays, 9 to 35 percent slopes	31.30	4.8%		Vle		9	29	15	22
3231	Monowi silty clay, 6 to 15 percent slopes	30.04	4.6%		IVe	IVe	10	29	15	23
3327	Verdel silty clay, 0 to 2 percent slopes	21.76	3.3%		IIIs	IIIs	47	46	25	41
2328	Inavale fine sandy loam, occasionally flooded	21.48	3.3%		IIIe	IIIe	37	43	33	32
3305	Reliance silt loam, 2 to 6 percent slopes	14.75	2.3%		IIIe	IIIe	60	52	38	51
9999	Water	11.57	1.8%				0			

Soils data provided by USDA and NRCS.