

2. Please use the space below to sketch the real property being sold and the location of each SEWER SYSTEM /WELL on the Property.  
 (circle all that apply)

3. Include approximate distances from fixed reference points such as streets, buildings and landmarks.

4. Property located at 1434 - 105th Ave Arden WI 54001  
 5. Folk County WI

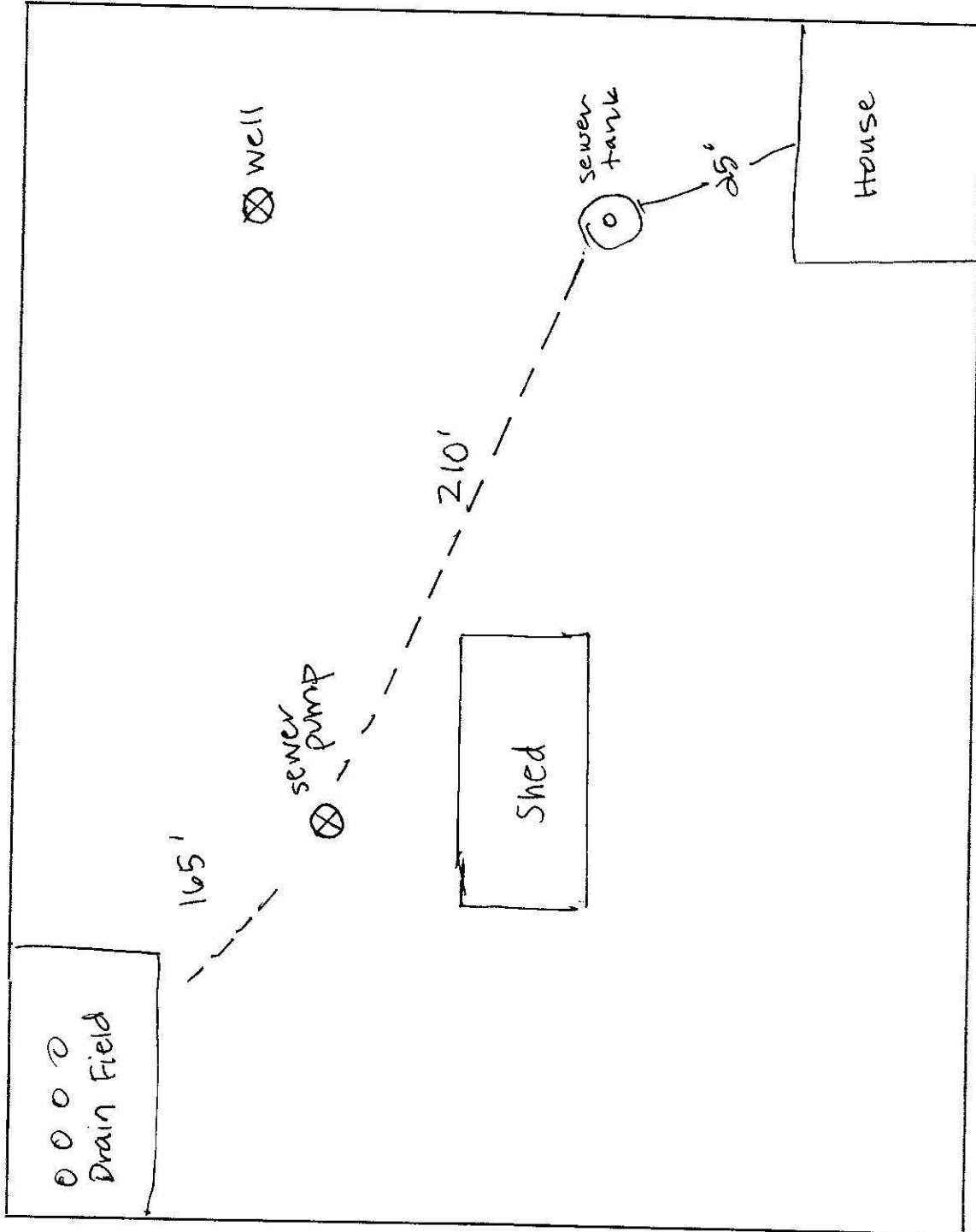

ATTACH ADDITIONAL SHEETS AS NEEDED

6. Seller and Buyer Initial: Seller(s) CRB GA Buyer(s) \_\_\_\_\_

7. ORIGINAL COPY TO LISTING BROKER; COPIES TO SELLER, BUYER, SELLING BROKER